

Beaully-Keith Innovation Submission

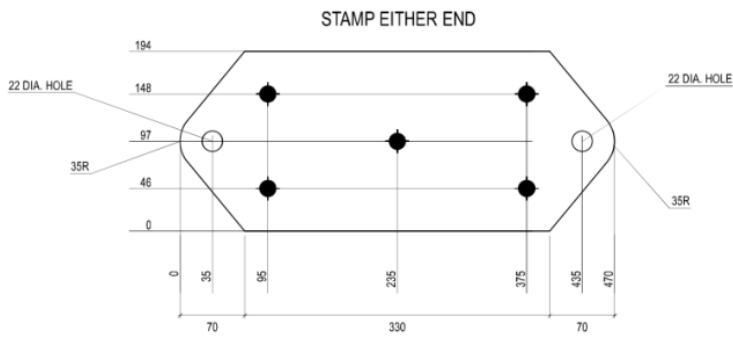

Original Design

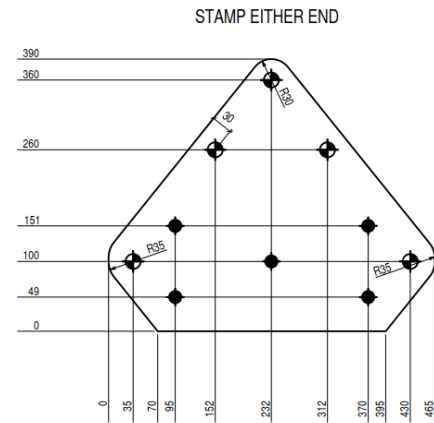

Improved Design

The maintenance plate is a bespoke fitting to aid in pulling the top wire on a transmission tower. The new plate design allows for the block (or pulley) required to pull the new wire to be hung just outside of the top of the steel structure.

This is beneficial as previously the block had to be attached within the structure by removing steel bars in the tower's peak so it eliminates any damage to the bars that could occur.

This innovative design reduces the time taken to install the block, hence reducing the amount of time working at height. Additionally, it decreases the amount of manual handling involved at height as the steel bars that are usually required to be removed would need to be lowered to ground level as well as lowering any shackles and chains required. It also provides an easier working position for the operatives as they can work from the outside of the structure and not have to deal with trying to attach things within the tight space in the peak.

